

ON-WALL

Office  
Area: 200 m<sup>2</sup> - 480 m<sup>2</sup>

# 01 CUSTOMER REQUESTS

- ≡ A sound system for background music and paging
- ≡ Music from radio, CD and MP3 player
- ≡ One paging zone, adjustable volume per room
- ≡ Paging should have priority over the music and volume control in the offices, not in the meeting rooms
- ≡ Stylish cabinet speakers to fit the interior style

# 02 FLOOR PLAN OFFICE

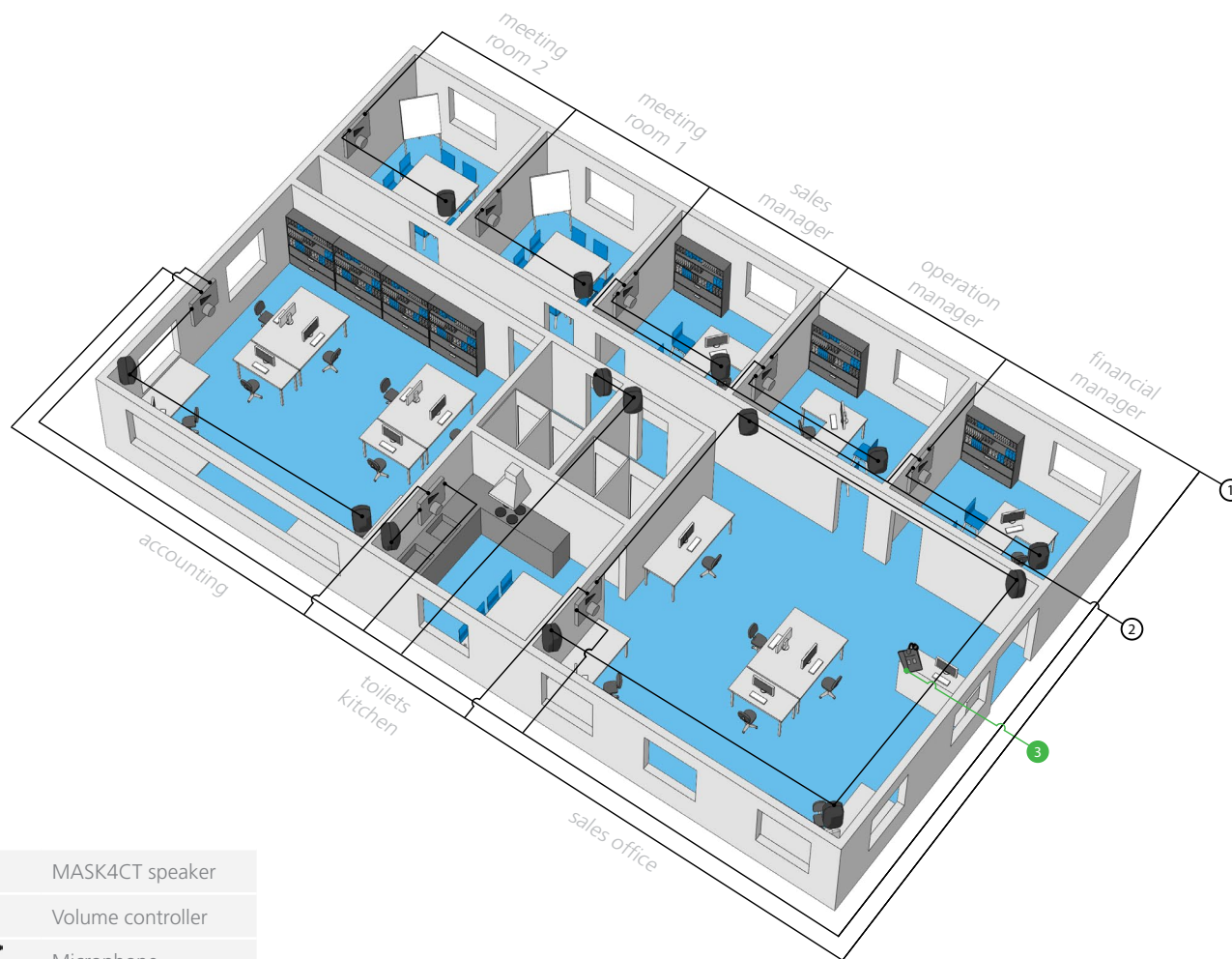

	MASK4CT speaker
	Volume controller
	Microphone
	Cable type F
	Cable type K
	Audio signal cable
	2-core speaker cable
	4-core speaker cable

## Corporate

Office, Reception, Sun centre, Waiting room, Tanning studio, Bank, ...

Is your project larger than the office in this example?

Check the other case studies in the corporate section of this book or contact your Apart dealer. He will help you to work out a project that exactly fits your clients requirements.

# 03 SPEAKER CHOICE

ZONE	SURFACE (m <sup>2</sup> )	SPEAKERS	POWER SETTING	COLOUR
financial manager	15-30 m <sup>2</sup>	1 x MASK4CT + E-VOL20	5 watts	
operation manager	15-30 m <sup>2</sup>	1 x MASK4CT + E-VOL20	5 watts	
account manager	15-30 m <sup>2</sup>	1 x MASK4CT + E-VOL20	5 watts	
meeting room 1	15-30 m <sup>2</sup>	1 x MASK4CT + E-VOL20	5 watts	
meeting room 2	15-30 m <sup>2</sup>	1 x MASK4CT + E-VOL20	5 watts	
sales office	60-120 m <sup>2</sup>	4 x MASK4CT + E-VOL20	5 watts	
toilets	20-40 m <sup>2</sup>	2 x MASK4CT	2.5 watts	
kitchen	15-30 m <sup>2</sup>	1 x MASK4CT + E-VOL20	5 watts	
accounting	30-60 m <sup>2</sup>	2 x MASK4CT + E-VOL20	5 watts	

# 05 SHOPPING LIST



**MASK4CT**  
4.2" cabinet speaker **14x**

**E-VOL20**  
20 watts euro volume controller **8x**

**MICPAT-D**  
1-zone table type dynamic microphone **1x**

**PCR3000RMKIII**  
DAB-FM tuner & CD-audio/MP3 via USB-key or SD slot **1x**

**MA120**  
70/100 volt mixing amplifier **1x**

**CABLE TYPE F**  
RCA - RCA cinch stereo **1x**

**CABLE TYPE K**  
RCA - mini-jack **1x**

**AUDIO CABLE**  
2 x 2 x 0.22 mm<sup>2</sup> audio signal cable **...m**

**SPEAKER CABLE**  
2-core 1.5 mm<sup>2</sup> **...m**

**SPEAKER CABLE**  
4-core 1.5 mm<sup>2</sup> **...m**



# 04 ELECTRONICS CHOICE

of this installation - The maximum power consumption of  
**190**  
watts

